

BASEMENT FLOOR PLAN

SCALE: 1/4" = 1'-0"

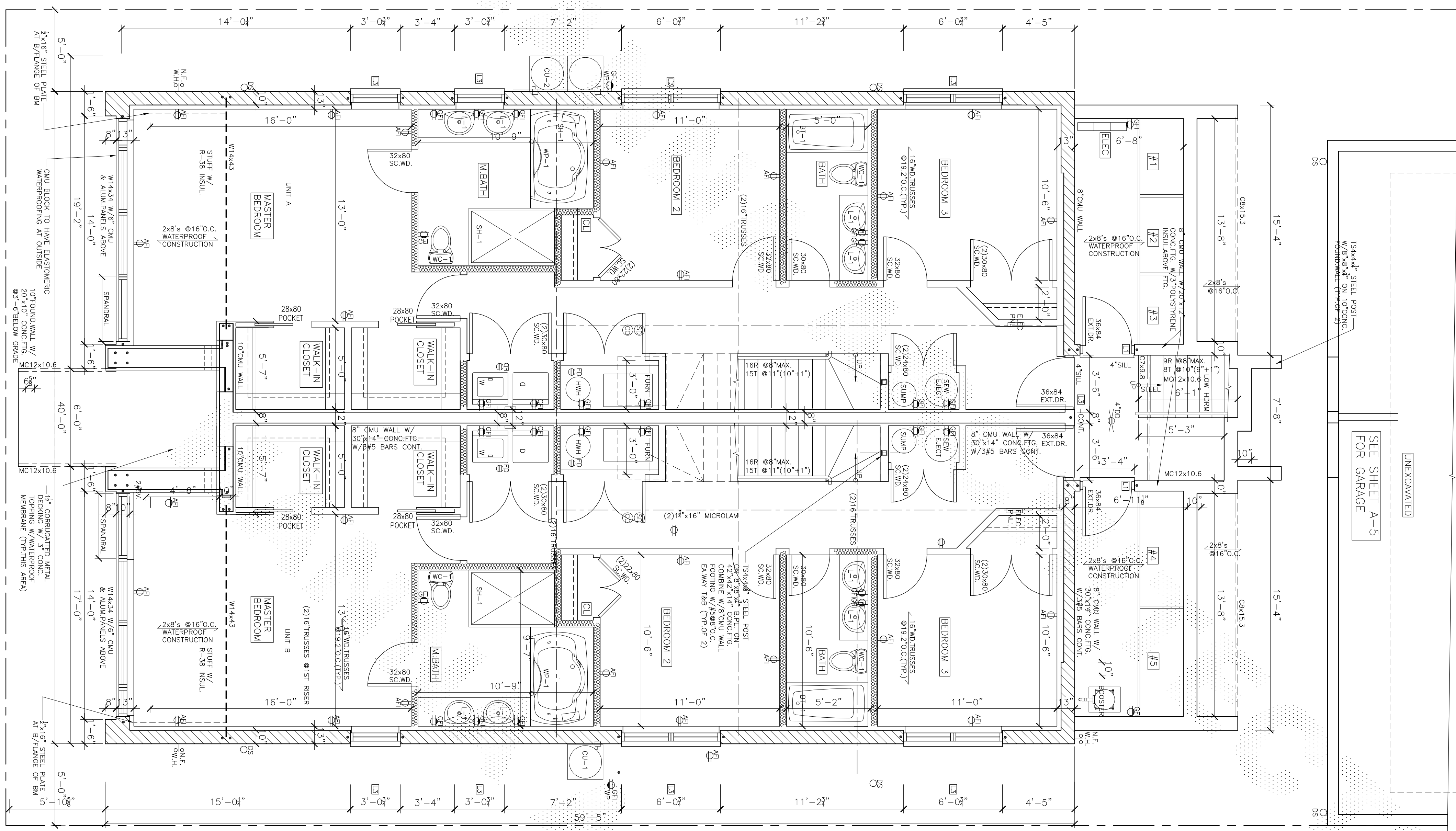

FIRST FLOOR PLAN

SCALE: 1/4" = 1'-0"

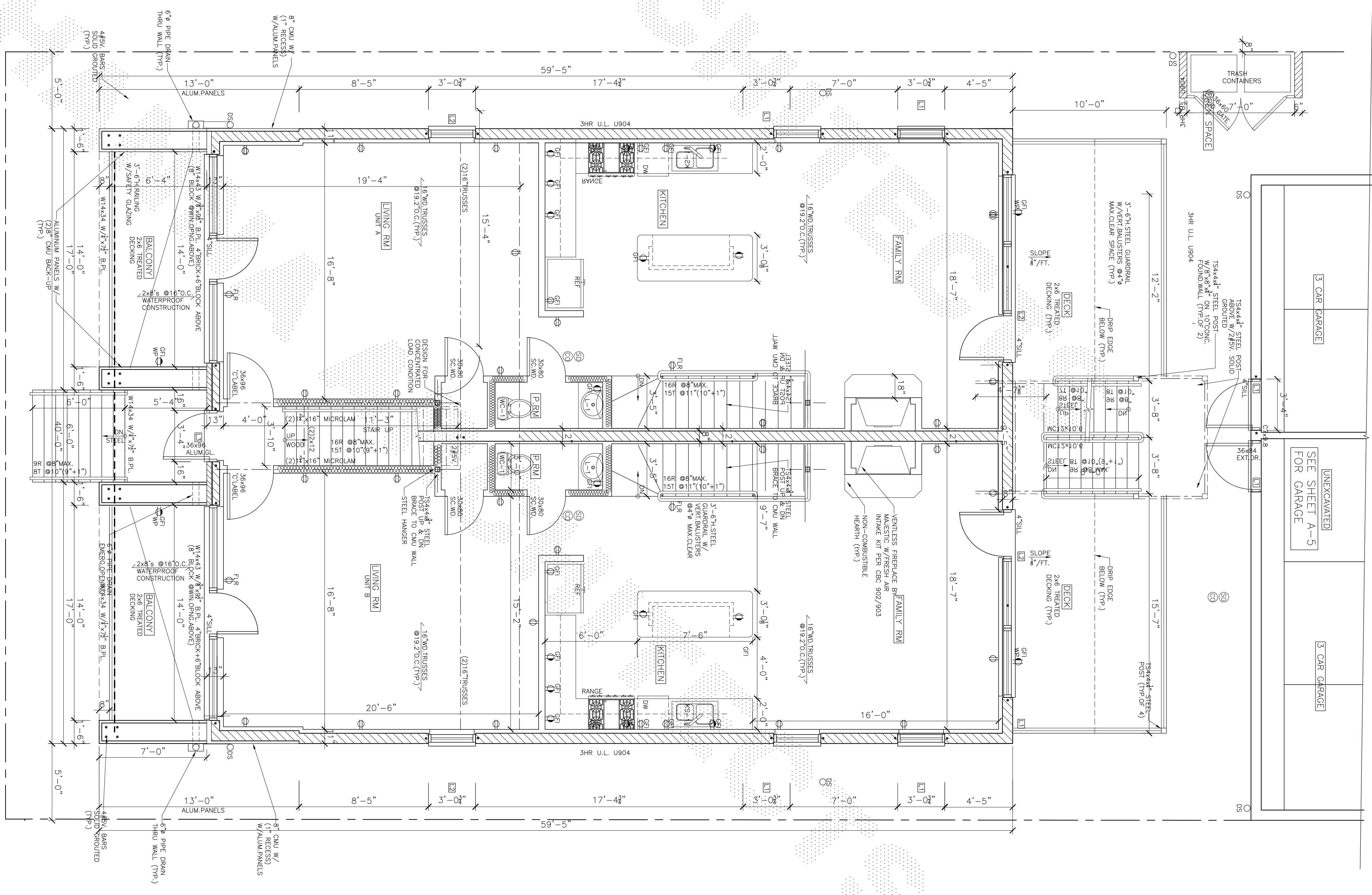

HANNA ARCHITECTS, INC. 2014

PROJECT NAME & ADDRESS
 3004-3006 W. LYNDALE
 5 UNIT APART.
 BLDG. W/BSMT.
 CHICAGO, ILLINOIS

SHEET TITLE
 BASEMENT &
 FIRST FLOOR
 PLANS

FILENAME
 SHEET NUMBER
 A-2

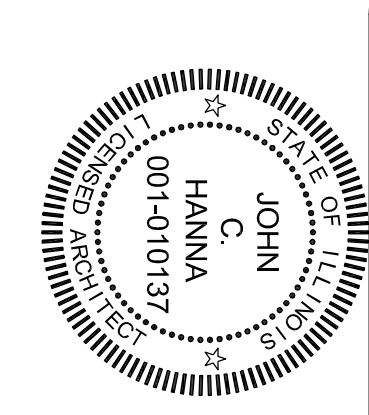

ISSUED FOR REVIEW
 ISSUED FOR PERMIT
 APRIL 23, 2014
 ISSUED FOR BID

WARNING:
 This plan protected under Copyright Law. No part of this plan may be reproduced with the Architect's office can be held responsible for any errors or omissions. To copy this plan, contact John Hanna (312) 750-1800

PROFESSIONAL DESIGN FIRM
 ARCHITECT CORPORATION
 LICENSE NUMBER 184-001485

180 W. WASHINGTON
 CHICAGO, ILLINOIS 60602
 FAX (312) 750-1801

HANNA
 ARCHITECTS, INC.

(312) 750-1800